

VITI A COLLETO CON GAMBO RETTIFICATO ISO 7379

SHOULDER SCREWS WITH GROUND SHAFT ISO 7379

NORMATIVA: ISO 7379
MATERIALE: ISO 12.9
TOLLERANZA GAMBO: "h8"
RESISTENZA ALLA ROTTURA PER TRAZIONE: 110-120 Kg/mm²
LIMITE DI ELASTICITÀ: 90 Kg/mm min
ALLUNGAMENTO: 9% min.
TOLLERANZA L1: +0/+0,05 mm

ACCORDING TO NORMATIVE: ISO 7379
MATERIAL: ISO 12.9
TOLERANCE OF SHAFT: "h8"
TENSIL STRENGTH: 110-120 Kg/mm²
LIMIT OF ELASTICITY: 90Kg/mm min
STRETCH: 9% min.
TOLERANCE OF L1: +0/+0,05 mm

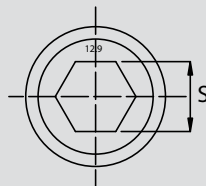
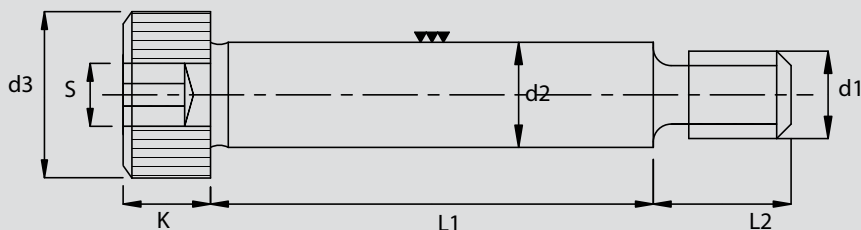

d3	8	10	13	16	18	24	30	36
K	4	4,5	5,5	7	9	11	14	16
L2	8	9,5	11	13	16	18	22	27
S	2,5	3	4	5	6	8	10	12
d1	M4	M5	M6	M8	M10	M12	M16	M20
d2 in "h8"	5	6	8	10	12	16	20	24
L1	PREZZI €							
10	1,45	0,92	1,17	-	-	-	-	-
12	1,50	0,96	1,17	-	-	-	-	-
15	1,55	1,00	1,20	1,40	1,60	-	-	-
16	1,55	1,00	1,20	1,40	1,60	-	-	-
20	1,65	1,05	1,25	1,45	2,00	-	-	-
25	1,70	1,09	1,30	1,50	2,10	3,50	-	-
30	1,85	1,19	1,40	1,55	2,15	3,55	6,80	-
35	1,95	1,22	1,40	1,60	2,25	3,60	7,10	-
40	2,05	1,27	1,50	1,65	2,30	3,70	7,40	12,80
45	2,40	1,41	1,50	1,70	2,45	3,80	7,73	13,25
50	2,60	1,47	1,55	1,80	2,45	3,95	8,43	13,71
55	Nuova dimensione / New dimension M4 x Ø 5	1,66	1,60	1,85	2,60	4,05	8,81	14,05
60		1,90	1,65	1,90	2,65	4,20	9,14	14,82
65		2,20	1,80	2,00	2,70	4,40	9,52	15,27
70		2,45	1,80	2,00	2,80	4,50	9,71	15,46
80		2,95	1,90	2,20	2,95	4,90	11,18	19,48
90		-	1,95	2,30	3,10	5,20	12,46	20,12
100		-	2,00	2,40	3,35	5,60	13,74	21,08
110		-	-	2,60	3,60	6,40	14,40	21,40
120		-	-	2,85	3,75	6,90	15,01	21,72
140		-	-	-	4,40	8,00	17,50	25,40
160	-	-	-	-	8,95	20,00	29,00	
200	-	-	-	-	12,30	25,00	36,20	